



Where Quality Meets Affordability



SHOWROOM & SALES

14501 E. Moncrieff Pl, Aurora, CO 80011

Mon-Fri: 8am-5pm

303.576.6677

DISTRIBUTION CENTER

8251 Quintero St, Commerce City, CO 80022

Mon-Fri: 8:30am-4:30pm

303.576.6677 x201

www.highlandcabinetryco.com
sales@highlandcabinetryco.com



FOLLOW US ON SOCIAL MEDIA!

COMMITMENT

**150,000+ sq. FT.
OF CABINETS IN STOCK**



Highland Cabinetry Colorado is a world-leading cabinet manufacturer and committed to our customers in stocking the largest kitchen and bathroom cabinet inventory in the Mountain West and shipping nationwide!

Allow us to help you keep your projects on schedule with reliable, durable materials and memorable customer service!

Our **100,000 sq. ft.** Distribution Center is located at 8251 Quintero Street in Commerce City, CO 80022, fully stocked and ready for pickups,

Our 50,000 sq. ft. Sales Showroom and Euro Warehouse remains at 14501 E. Moncrieff Place, Aurora, CO 80011.



LIMITED LIFETIME WARRANTY

THIS LIMITED WARRANTY IS SUBJECT TO ALL LIMITATIONS, EXCLUSIONS, DISCLAIMERS, APPROVAL, AND PROCEDURES.

As a direct manufacturer, Highland Cabinetry Colorado "HCC" is confident in the cabinets we sell. We stand behind our products and offer a one-of-a-kind Limited Lifetime Warranty. FIRST year immediate claim processing. Two (2) years + will have a 6-12 week lead time for processing. Proof of Purchase AND a Warranty Claim Form must be presented to begin the warranty claim process. If you have a warranty claim, please contact Highland Cabinetry Colorado at 303-576-6677 and fill out the Warranty Claim Form with a detailed description and pictures of the defects or damage you are experiencing with our products. Email the form, pictures, and details to warranty@highlandcabinetryco.com and upon receiving your email, we will let you know of our decision to repair or replace the defective product. DO NOT PROCEED TO THE NEXT STEP WITHOUT THE PRIOR WRITTEN CONSENT OF HIGHLAND CABINETRY COLORADO. HCC will be responsible for all shipping and handling fees if a valid claim is approved. Return of defective product, at the customer's expense, IS required for a replacement to be issued.

For a period of ONE YEAR from the original purchase date, HCC warrants to the original purchaser that cabinetry, door hinges, and drawer glides will be free from defects in material and workmanship under normal use and service. We will process these first-year claims as promptly as possible. This warranty is not transferable and only applicable to product used for single family owner occupied residential purposes. This warranty does not cover normal wear and tear, damage or defects caused by accidents, misused, or abused items, mishandled or improperly installed items, improperly stored items, customized or modified items, or items that are subject to extreme temperature or moisture level.

Upon entering the SECOND year, this warranty is extended to a Lifetime Warranty and all warranty claims processes will remain in effect. Proof of Purchase required. Please allow a 6-12-week lead time for processing these claims. These processing times for HCC warrants to the original purchaser that cabinetry, door hinges, and drawer glides will be free from defects in material and workmanship under normal use and service. Covers all products that are still available in our inventory and/or not discontinued.

Natural woods may vary in color and grain pattern. Just as no two trees are alike, no two pieces of wood are alike. The variation in color and grain pattern in the wood adds to its natural beauty and is not considered an imperfection. Environmental factors, including but not limited to artificial / natural light, moisture, cleaners, smoke, etc. may cause the darkening or mellowing of the cabinet over time. This is a natural process and can be expected. This warranty does not cover the natural aging or darkening / mellowing of wood color, the inherent growth characteristics of, or variation in wood.

Wood is wood, expansion and contraction still happens year after year as it compensates and adjusts to ever changing atmospheric humidity and temperature conditions. Therefore, warping of less than 1/4" is not considered a defect. The purchaser agrees to let doors that are warped 1/4" or more to hang for two seasons before replacement is requested. Typically, a door will return to its normal flat position once it is acclimated to temperature, and humidity conditions. Prior to requesting a replacement for a warped door, please be sure the door has been installed properly and hinges are adjusted correctly.





LIMITED LIFETIME WARRANTY

Stain variations: since no two trees are the same, wood is a unique material with natural variations in grain, texture, and color. These variations may also cause considerable differences between old samples and new cabinets. Please Note: Newly produced cabinets will never be the same color as aged samples or cabinets. Color changes may occur in the finished wood products. As a result of exposure to light and other elements which are part of the aging process. These material variations and changes are not covered by this warranty.

Some of the cabinet lines feature a glazed finish which accentuates the door and drawer front profiles. This glaze is hand applied over a stain or paint and may, due to the nature of application, consist of random drips, runs, etc. As glazing is a hand applied process there will be variations in color and appearance from door to door and cabinet to cabinet. This is not considered a defect and is considered normal with hand applied finishes. Cabinet lines with painted surfaces may show fractures in the paint at the joints. This is normal and is not considered a defect.

At our discretion, we may elect to repair or replace a cabinet with a functionally equivalent product covered by this warranty. Some replacement parts are subject to stock availability and may differ from original parts received. Return of defective product IS required for a replacement to be issued. Repair parts or replacement parts are at the expense of Highland Cabinetry Colorado. This warranty does not include or cover the cost of installation, adjustments, removal, subsequent damage, or transportation of the defective product. This is regardless of whether work was performed by a contractor, service company, or yourself. To obtain service under this warranty, please contact the business from whom you purchased this product. A copy of the original purchaser's dated receipt must be submitted with all claims to preserve rights under this warranty.

This warranty is non-transferable. Highland Cabinetry Colorado reserves the right to inspect the claimed defective cabinets. No returns, replacements or repairs may be made without prior written consent.

This warranty is the sole warranty of Highland Cabinetry Colorado. No dealer, distributor or agent possesses any authority whatsoever to modify or enlarge the above warranty in any way.



SHAKER CABINET FEATURES

5 Piece Door and Drawer Fronts.

*Painted doors are High Density Fiber (HDF).

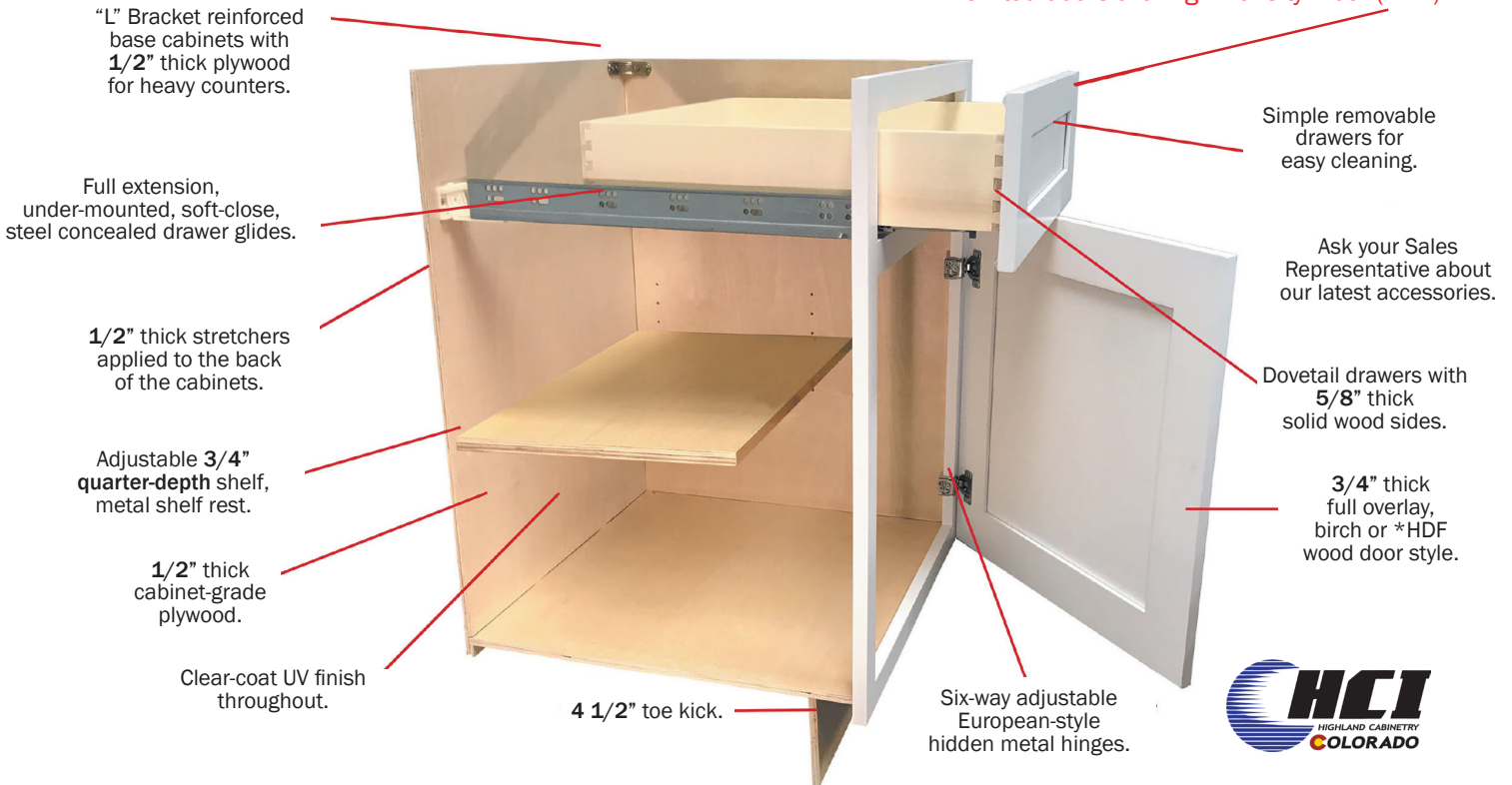

CABINET STYLES

MOUNTAIN
TIMBER



ESPRESSO
SHAKER



MODERN
SLATE SHAKER

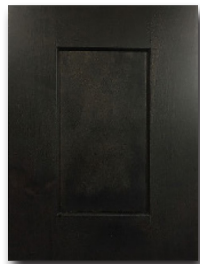

WHITE
SHAKER



GREY
SHAKER



SIGNATURE
BLUE SHAKER



ONYX
SHAKER



DOVE WHITE
SLIM SHAKER

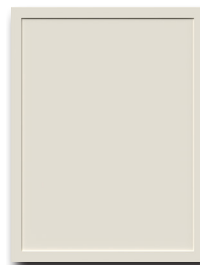

SAIGE GREEN
SLIM SHAKER



WHOLESALE CABINETS

WHITE SHAKER PAINTED

Wood: Painted or Stained, Birch, High Density Fiberboard (HDF)
Full overlay door panel, 3/4" thick door panel

Door Panel: Recessed door style, reversed raised door panel on the back
Painted surfaces are made of HDF.

Drawer: 5/8" thick cabinet grade plywood sides
with full extension, under-mounted, soft-close,
steel concealed drawer glides

Interior: Natural clear coat finish

Box: 1/2" thick cabinet grade plywood with metal
L-bracket reinforcements for base cabinets

Hardware: 6-way adjustable 1 1/4" hinge with soft
closing insert

Shelf: Quarter-depth, adjustable 3/4" thick cabinet
grade plywood, metal shelf rests

Warranty: Limited Lifetime Warranty



WHOLESALE CABINETS
PAINTED **GREY SHAKER**



WHOLESALE CABINETS

ESPRESSO SHAKER STAIN



STAIN **MODERN SLATE SHAKER**



WHOLESALE CABINETS

SIGNATURE BLUE PAINTED



WHOLESALE CABINETS
PAINTED **ONYX SHAKER**



WHOLESALE CABINETS

SLIM SAIGE GREEN PAINTED



WHOLESALE CABINETS
PAINTED **SLIM DOVE WHITE**



INTRODUCING OUR VERY OWN

Frameless Collection

Presenting Highland Cabinetry Colorado's exclusive Frameless Collection – a novel range of European-styled cabinets meticulously crafted to enhance your kitchen and bathroom areas. Constructed with enduring melamine in the Classic doors and utilizing engineered furniture board in the Deluxe doors, these cabinets showcase modern frameless design that maximizes space efficiency while ensuring robust and refined aesthetics. The discreet hinges and full-overlay doors contribute to the sleek lines and minimalist allure characteristic of European cabinetry, bringing both style and practicality to your everyday life. At Highland Cabinetry Colorado, our dedication lies in crafting living spaces that seamlessly merge sophistication and innovation. This line exemplifies our commitment, offering adaptable cabinetry solutions for contemporary living. Enhance your living space with Highland Cabinetry Colorado – a fusion of superior craftsmanship and contemporary design, delivering an unparalleled home experience.

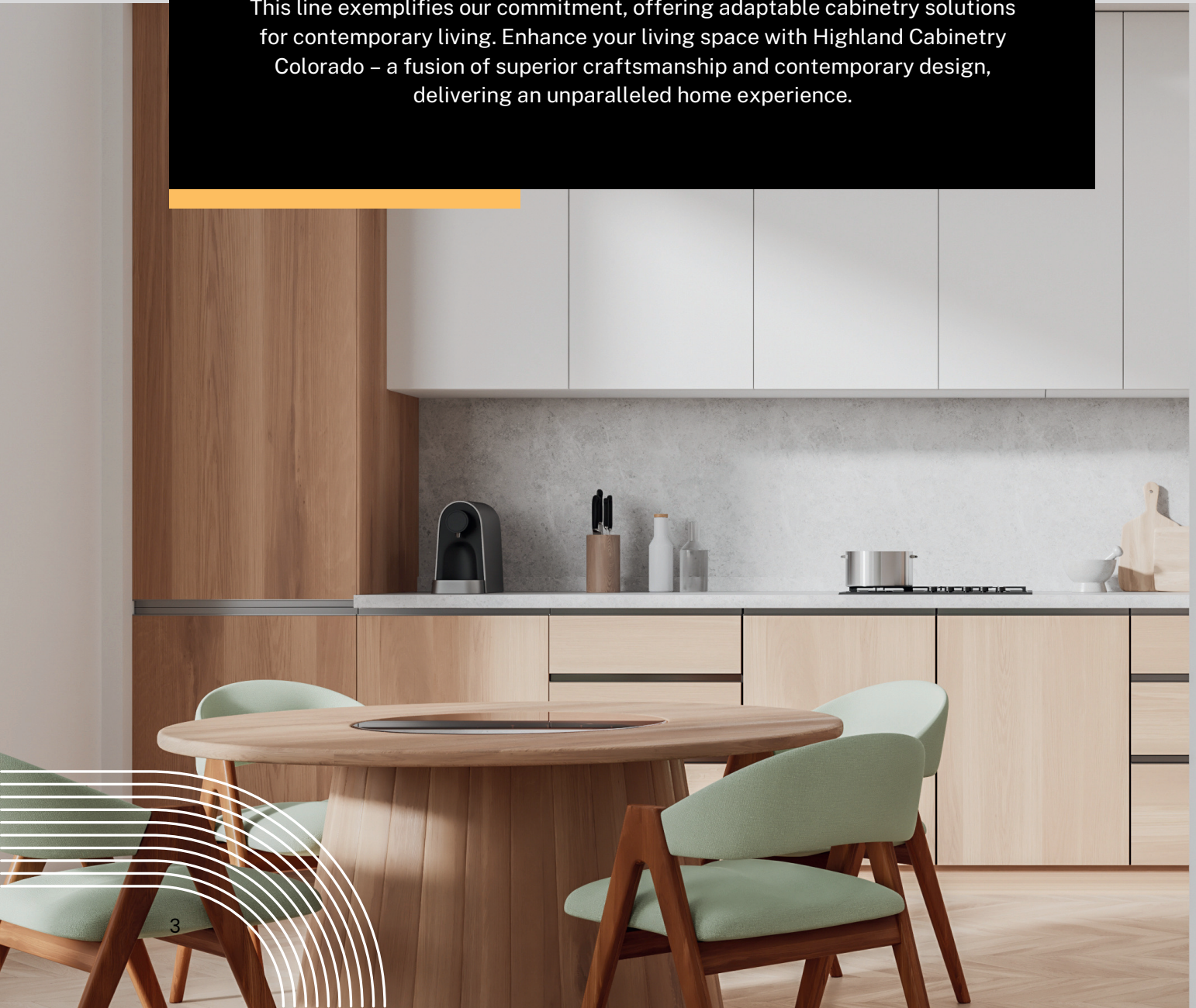

MATERIALS FACTS

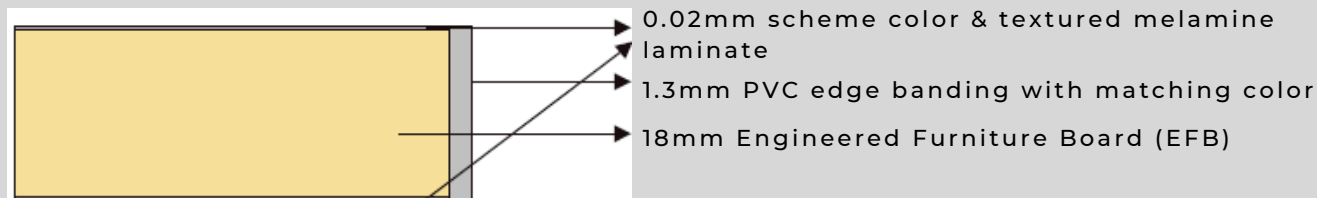

Product Specifications - Classic Series Doors	
Core Material	EPA Title VI compliant partical board
Coating Finish	0.02mm melamine laminate
Back Finish	
Edge Banding	1.3mm PVC edge banding with matching color & texture
Features	Environemntally friendly material Significant cost advantage Vivid wood texture & color Never fading, no color difference between doors

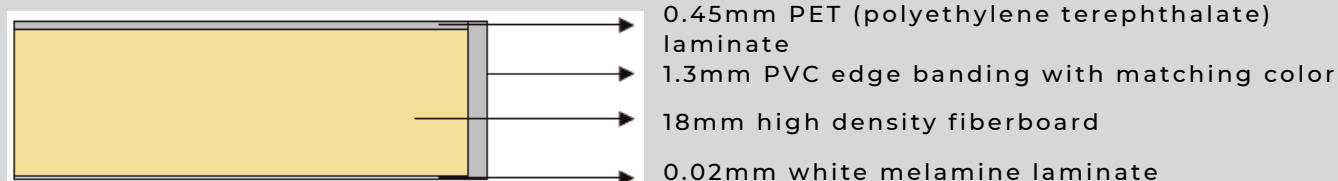

Product Specifications	
Core Material	EPA Title VI Compliant medium density fiberboard.
Coating Finish	0.45mm PET (polyethylene terephthalate) laminate.
Back Finish	0.02mm white melamine laminate.
Edge Banding	1.3mm PVC laser edge banding with matching color.
Features	Moisture resistance, acid and alkali tolerant. Highgloss & vidi color finishes. Easy to clean. Anitbacterial, safe for direct food contact. Never fading, no color difference between doors.

COLLECTION STRUCTURE

Highland Cabinetry is designed for lasting use, crafted with care to meet precise standards using engineered furniture board. Our European Frameless collection features fully adjustable hinges and drawer glides with soft-close technology for a touch of luxury. We keep it simple yet reliable, ensuring that this line brings a touch of enduring style and convenience to your spaces.



Cabinet Structure

1. Door Panel
2. 6-way adjustable soft-close hinge
3. 3/4"(18mm) melamine laminated shelf
4. 1/4" (6mm) back panel with top and bottom enforced rail
5. 3/4"(18mm) engineered furniture board side panels with toe kick
6. 5/8"(16mm) melamine laminated bottom & back panels of the drawer
7. Premium metal drawers with 90° sides
8. Conformat connecting system for easy and more durable assembly
9. Full access 6-way adjustable soft-close drawer system

DELUXE COLORS

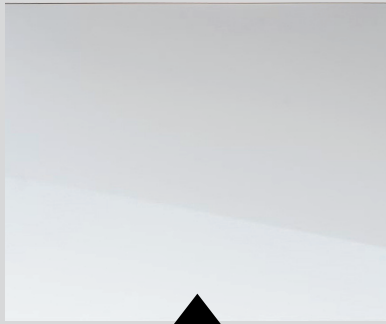

GLOSS WHITE

Gloss White redefines cabinet design with its modern, seamless profile. This option exudes timeless sophistication, perfect for elevating kitchens and bathrooms with durability and easy maintenance.



MATTE WHITE

Matte White cabinets feature modern sophistication in matte white. Ideal for kitchen or bathroom remodels, adding a timeless and fresh touch to contemporary designs.

CLASSIC FINISHES

NATURAL OAK

Elevate your remodel with Natural Oak – a seamless, timeless cabinet design in light natural wood finish for sophistication, durability, and easy maintenance in kitchens and bathrooms.

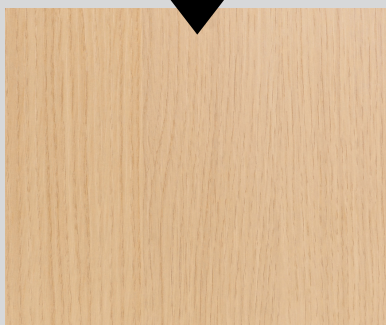

WALNUT

Perfect for kitchens and bathrooms, they exude enduring charm while keeping maintenance hassle-free. Let your space reflect your unique style with a touch of Walnut sophistication.



Deluxe (PET) - Classic (Melamine)

CUSTOM FINISHES & COLORS



HG = HIGH GLOSS | SM = SUPER MATTE | Please contact us for details.



Gloss White





Matte White





Natural Oak





Walnut

